

Three Important Carpool Procedures to Follow (Times reflect full days)

1) Afternoon Carpool ARRIVAL TIMES

- Picking up **LS ONLY** – arrive between 2:35 and 2:45pm
- Picking up **BOTH LS** and **US** – arrive between 2:50 and 3:00pm
- Picking up **US ONLY** – arrive between 3:05 and 3:15pm

These arrival times will minimize your wait and will help keep us from backing up on Baileywick Rd.

2) Morning Carpool DROP-OFF LOCATIONS

ALL LS students should be dropped off in front of Building 3 at the Blue Canopy Sidewalk

ALL US students should be dropped off in front of the Upper School Building – **PLEASE DO NOT drop off any US students in the LS carpool.** It is dangerous for your child to cross vehicular traffic that is entering LOT C. **For their safety – ONLY Drop-Off US students at the US Building.**

3) Lane Choices – Entering and Navigating the Traffic Circle **1** (see this section on the map)

Whether you are coming for morning or afternoon carpool, please follow these procedures.

- **LS carpool** (that includes **mixed** carpool of **LS/US** because you drop-off/pick-up LS first).
 - **Enter campus** in the **RIGHT** lane primarily, but you can use the left lane as well.
 - Once you make the sharp right turn into LOT A, use **BOTH** lanes.
 - As you **exit LOT A** at the YIELD sign (where Dr. Breazeale is stationed), you have **two choices**:
 - ✓ **Exiting campus** – choose the **LEFT** lane in traffic circle
 - ✓ **Going to US building** to drop-off/pick-up – choose the **RIGHT** lane in traffic circle

LS is indicated by the orange arrows on the map.



- **US carpool** (if this is your first and only destination)
 - **Enter campus** in the **LEFT** lane.
 - Once you reach the traffic circle, it is one lane of traffic, but
 - ✓ On the **back side of the traffic circle**, choose the **RIGHT** lane to take you to the US Building.

US is indicated by the orange arrows on the map.



Student Drivers – **LANE CHOICE is always LEFT** lane entering campus, then single lane beside traffic circle as you enter LOT C.

Carpool Clarification 8/16/23

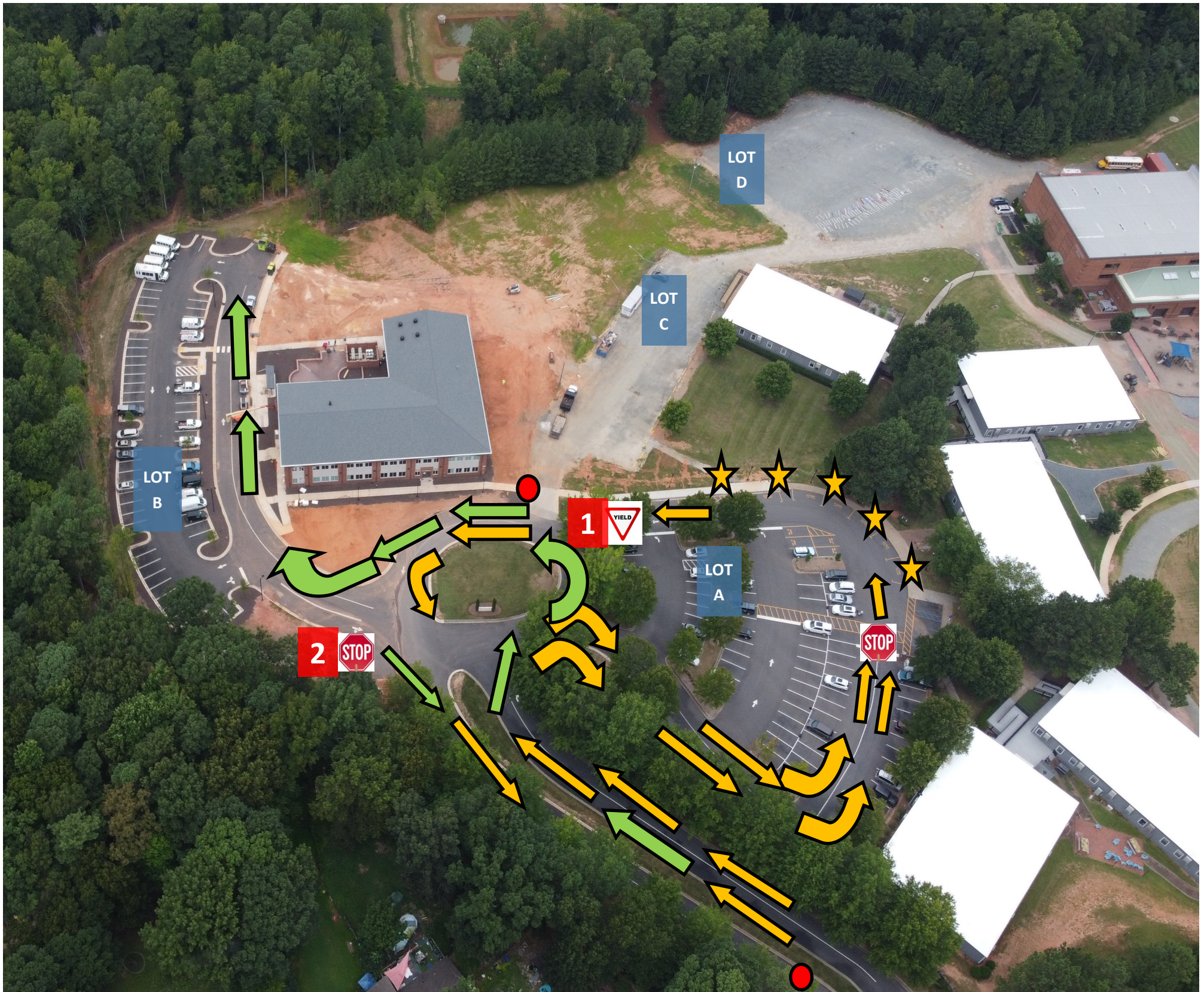

3) Lane Choices – Entering and Navigating the Traffic Circle **1** (see this section on the map)

Whether you are coming for morning or afternoon carpool, please follow these procedures.

- **LS carpool** (that includes **mixed** carpool of **LS/US** because you drop-off/pick-up LS first).
 - **Enter campus** in the **RIGHT** lane primarily, but you can use the left lane as well.
 - Once you make the sharp right turn into LOT A, use **BOTH** lanes.
 - As you **exit LOT A** at the YIELD sign (where Dr. Breazeale is stationed), you have **two choices**:
 - ✓ **Exiting campus** – choose the **LEFT** lane in traffic circle
 - ✓ **Going to US building** to drop-off/pick-up – choose the **RIGHT** lane in traffic circle

LS is indicated by the orange arrows on the map. 

- **US carpool** (if this is your first and only destination)
 - **Enter campus** in the **LEFT** lane.
 - Once you reach the traffic circle, it is one lane of traffic, but
 - ✓ On the **back side of the traffic circle**, choose the **RIGHT** lane to take you to the US Building.

US is indicated by the orange arrows on the map. 

Student Drivers – **LANE CHOICE** is always **LEFT** lane entering campus, then single lane beside traffic circle as you enter LOT C.